

Remote Installation from the Edge of the Excavation

- 1) Viking Johnson Remote EasiClamp & EasiTap products come pre-assembled with EPDM gaskets (WBS approved for use with potable water) and can only be used on applications suitable for this type of compound.
- 2) The product is factory lubricated from the tip of the overlap, around to the back of the overlap, extending just beyond the stainless steel plate. If the lubricant is removed, it is important that a silicone based WRAS approved lubricant is re-applied to this area.
- 3) Prepare the pipe surface, ensuring that the main is free from loose surface deposits, mud, rust, scale etc. When being installed on dry bitumen coated ductile iron pipe a thin smear of water quality approved pipe jointing lubricant should be applied to the gasket in the Remote EasiClamp & EasiTap products.
- 4) Opening up the Clamp for Installation on Pipe

The bolts and nuts in the Viking Johnson Remote EasiClamp & EasiTap products are pre-set and retained in the product by means of plastic clips and should not be removed from the clamp prior to installation.

To open up the clamp simply swing bolt head out away from body of clamp sufficient to clear bolt lug. (See Fig A)

NOTE DO NOT swing bolt excessively. Keep the clamp loosely closed to avoid contact with the ground and other debris that could be a source of contamination.

CAUTION During this operation DO NOT pick up or use the bolts or gasket to hold the clamp during installation as this may result in dislodgement of the bolts, gasket or plastic retainers. (See Fig B)
- 5) Attaching Installation Tool to Remote EasiClamp or EasiTap

Squeeze the “brake handle” to release the lock pin on the end of the Installation Tool and insert the pin into the location lug on the Remote EasiClamp or EasiTap product. (See Fig C, D & E)

Repeat exercise whereby both ends of the Installation Tool are located on the Remote EasiClamp or EasiTap.
- 6) Using the Installation Tool open up the Remote EasiClamp or EasiTap products and lower it down onto the crown of the pipe. (See Fig F)
- 7) Once located on the crown of the pipe, draw together the two arms of the Installation Tool so that the two half housings drop round the pipe until the bolts click into place over the lugs. (See Fig G)

- 8) Using the “brake handle” release the lock pin on the side of the Remote EasiClamp or EasiTap adjacent to the “Nut Head Pin” and then rotate the product in the direction shown to bring the bolts heads facing upwards, or in a convenient position to be tightened with the extended socket. (See Fig H)
- 9) Tightening of the Bolts

Work between the two bolts turning each one a couple of turns at a time until the recommended bolt torque is achieved. (See Fig I)

For ease of assembly it is permissible to wind one bolt up fully to finger tight before starting on the second bolt. Once finger tight alternate between bolts turning each one a couple of turns until the recommended bolt torque is achieved.

To simplify installation further, the use of a Viking Johnson Extended T-Bar Socket (Fig. J) will allow bolts to be easily tightened from either within or outside the trench. The tool has facility to fit a torque wrench to the top to verify acceptable torque levels (Fig. K). Part numbers VJ16225 - 1.5m in length, VJ16725 - 1m in length.

Final bolt up must be verified using a torque wrench positioned on the top of the nut form on the extended socket.
- 10) Bolt Size = M16
Spanner Size = A/F24mm
Recommended Bolt Torque = 95Nm to 120Nm
- 11) Release last pin holding the Installation Tool on the Remote EasiClamp or EasiTap product.

CAUTION

- The maximum bolt torque noted above MUST not be exceeded.
- Leakage can NOT be prevented by over tightening of the bolts.
- Excessive over tightening of the bolts on the product may damage the repair clamp and in extreme circumstances cause personal injury.
- The Viking Johnson Remote EasiClamp & EasiTap products are designed to deform to adopt the shape of the pipe and therefore it is not possible to reuse them after full installation.
- Always observe appropriate Health and Safety procedures relevant for working in this type of environment

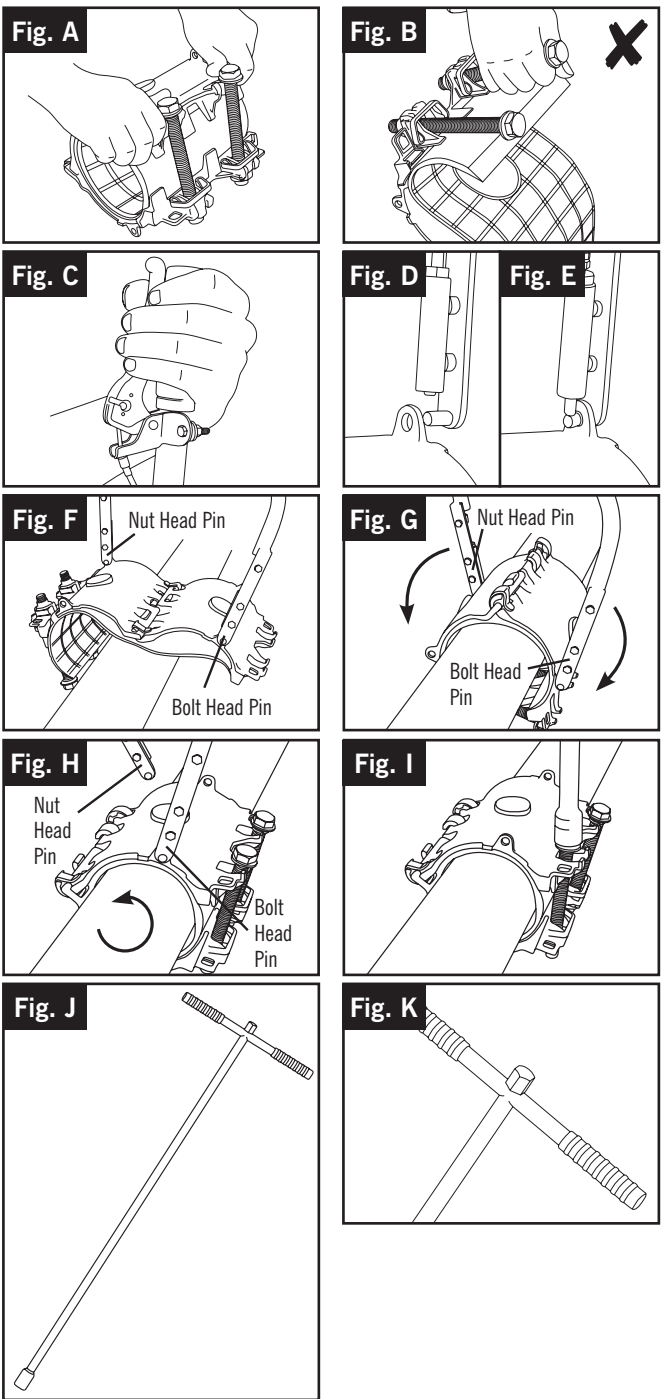

Versatile

Remote
EasiClamp & EasiTap
Remote & Manual Installation Instructions

HW HYGRADE
WATER

Remote EasiClamp
water dragons
SBWWI 2010
Best Product Innovation



PIPE CONNECTIONS, REPAIR & FLOW CONTROL PRODUCTS FOR THE UTILITIES INDUSTRY

Versatile Remote EasiClamp & EasiTap

Remote & Manual Installation Instructions



46-48 WILBURY WAY
HITCHIN, HERTFORDSHIRE
SG4 0UD. UNITED KINGDOM

Every effort has been made to ensure that the information contained in this publication is accurate at the time of publishing. Crane Ltd assumes no responsibility or liability for typographical errors or omissions or for any misinterpretation of the information within the publication and reserves the right to change without notice.

Manual Installation in Trench Adjacent to Damaged Pipe

- 1) Viking Johnson Remote EasiClamp & EasiTap products come pre-assembled with EPDM gaskets (WBS approved for use with potable water) and can only be used on applications suitable for this grade of compound.
NOTE DO NOT dismantle prior to installation on pipe.
- 2) The product is factory lubricated from the tip of the overlap, around to the back of the overlap, extending just beyond the stainless steel plate. If the lubricant is removed, it is important that a silicone based WRAS approved lubricant is re-applied to this area.
- 3) Prepare the pipe surface, ensuring that the main is free from loose surface deposits, mud, rust, scale etc. When being installed on drybitumen coated ductile iron pipe a thin layer of water quality approved pipe jointing lubricant should be applied to the pipe surface.
- 4) **Opening up the Clamp for Installation on Pipe**
The bolts and nuts in the Viking Johnson Remote EasiClamp & EasiTap products are pre-set and retained in the product by means of plastic clips and should not be removed from the prior to installation.

To open up the clamp simply swing bolt head out away from body of clamp sufficient to clear bolt lug. **(See Fig 1)**

NOTE DO NOT swing bolt excessively.

Open up the clamp, ensuring the gasket is facing up and not in contact with the ground to avoid contamination with debris that may stick to the gasket, which could contaminate the water supply or inhibit the seal on the pipe.

CAUTION During this operation DO NOT pick up or use the bolts or gasket to hold the clamp during installation as this may result in dislodgement of the bolts, gasket or plastic retainers. **(See Fig 2)**

5) Installation of Clamp on Pipe

NOTE When installing a Viking Johnson Remote EasiClamp product on a damaged pipe we recommend that it is initially positioned adjacent to the damaged section. Once the bolts are hooked in place and the clamp rotated to permit easy tightening of the bolts it can be slid over the damaged area to effect a repair.

- 6) Place the clamp around the pipe with the hinge resting on the top of the pipe facing upwards.
- 7) Let the two half housing drop round the pipe until the bolts click into place over the lugs. **(See Fig 4)**
- 8) Rotate the clamp in the direction that brings the bolt heads facing upwards, or in a convenient position to be tightened with a standard socket / spanner. **(See Fig 5)**

NOTE Ensure the gasket leading edge is correctly located within the mating clamp half.

9) Tightening of the Bolts

Work between the two bolts turning each one a couple of turns at a time until the recommended bolt torque is achieved. **(See Fig 6)**

For ease of assembly it is permissible to wind one bolt up fully to finger tight before starting on the second bolt. Once finger tight alternate between bolts turning each one a couple of turns until the recommended bolt torque is achieved.

To simplify installation further, the use of a Viking Johnson Extended T-Bar Socket **(Fig. 7)** will allow bolts to be easily tightened from either within or outside the trench. The tool has facility to fit a torque wrench to the top to verify acceptable torque levels **(Fig. 8)**. Part numbers VJ16225 - 1.5m in length, VJ16725 - 1m in length.

Final bolt up must be verified using a torque wrench.

- 10) Bolt Size = M16
Spanner Size = A/F 24mm
Recommended Bolt Torque = 95Nm to 120Nm

CAUTION

- The maximum bolt torque noted above MUST not be exceeded.
- Leakage can NOT be prevented by over tightening of the bolt.
- Excessive over tightening of the bolts on the product may damage the repair clamp and in extreme circumstances cause personal injury.
- The Viking Johnson Remote EasiClamp & EasiTap products are designed to deform to adopt the shape of the pipe and therefore it is not possible to reuse them after full installation.

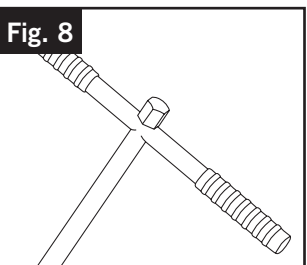
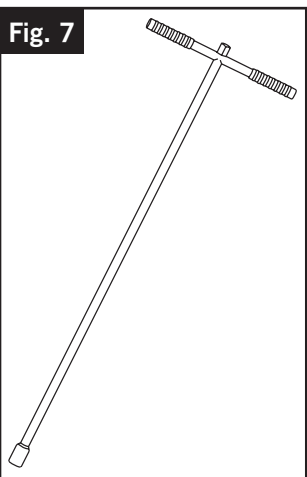
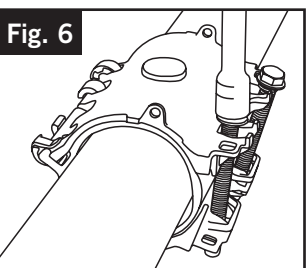
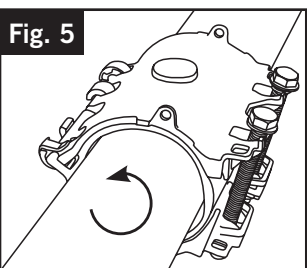
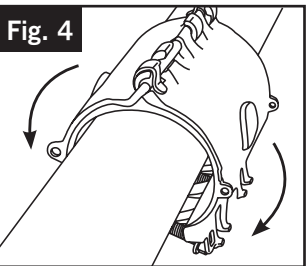
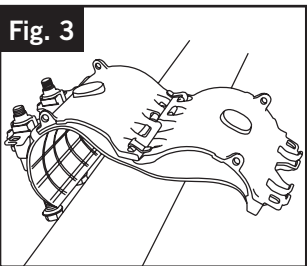
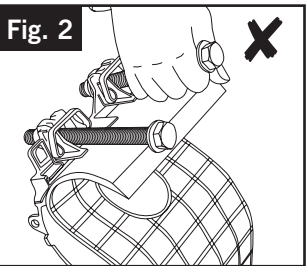
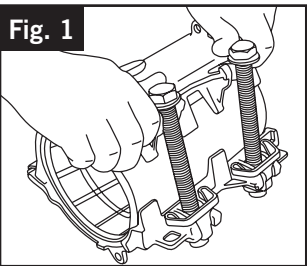

DR5694_02_2011