

Ball Check Valve

Check valves for waste water and raw water service.



TECHNICAL GUIDE: **VH4.1**

Applications

Waste water

Pump station

River water

Product Attributes

Non fouling

Full bore

Horizontal or vertical installation

Approvals/Standards

Flanges to AS 4087-B5

EN 558-1 face to face

Quality

ISO 9001:2008 Quality
Management Standard

Features

- Full bore ductile iron body
- Higher pressure rating compared to other ball checks
- Self-cleaning sinking nitrile coated ball
- Inside and outside epoxy-coating
- Low pressure drop
- Removable bonnet for cleaning or changing the ball without disassembly out of the pipeline
- Horizontal and vertical installation in the pipeline
- Light weight design for easy installation

Options

- Other flange connections
- Size above 500 mm available
- Various ball types including floating type ball

Technical Data

- Size range:
 - DN50 - DN500 (Flanged)
 - DN32 - DN65 (Threaded)
- Pressure classes: PN16
- Face to face: EN-558-1 series 48 (DIN3202 F6)
- Temperature range: 10°C to +80°C
- Threaded connection: BSP
- Flange drilling: AS4087 CL16
- Leakage tests: EN 12266
- Coating: fusion bonded epoxy
- Minimum backpressure: 0.3 - 0.5bar



FIG. 1

TABLE 1 Series Threaded Connection

DN	FxF	H1	ØD	Weight (kg)
32	135	72	50	2
40	145	85	60	2
50	175	100	70	3
65	200	125	90	5

TABLE 2 Material specifications and parts list

No	Description	Material
1	Body	Ductile Iron
2	Bonnet	Ductile Iron
3	Ball	Steel & NBR (standard) Steel & EPDM (optional)
4	Bonnet Gasket	NBR (standard) EPDM (optional)
5	Bolts	Stainless Steel

TABLE 3 Series Flanged Connection

DN	FxF	b	h1	ØD	ØD1	ØD2	n-Ød1	Weight (kg)
50	200	19	100	165	125	90	4-18	6.5
65	240	19	125	185	145	103	4-18	11
80	260	19	136	200	160	122	4-18	14.35
100	300	20	185	220	180	154	4-18	19.98
125	350	20	196	250	210	186	8-18	30.4
150	400	23	265	285	240	207	8-18	42.3
200	500	23	340	340	295	264	8-18	73.5
250	600	24	420	405	355	328	8-22	128
300	700	30	480	460	410	374	12-22	180
350	800	33	580	505	470	438	12-26	290
400	900	33	730	580	521	490	12-26	420
500	1100	33	900	705	641	609	16-26	580

Note: Dimensions (mm)

Mounting in Pipeline

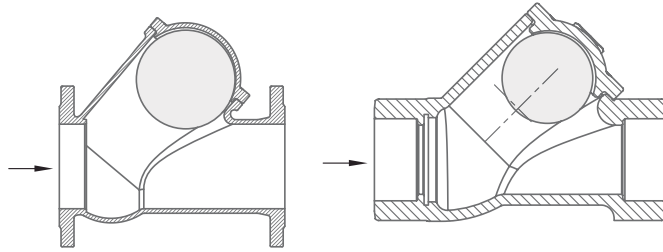

FIG. 4 Horizontal Installation

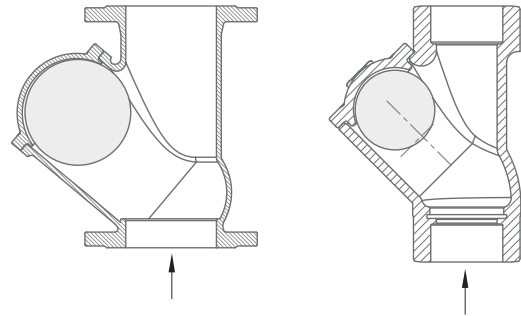

FIG. 5 Vertical installation

Dimensional Drawing

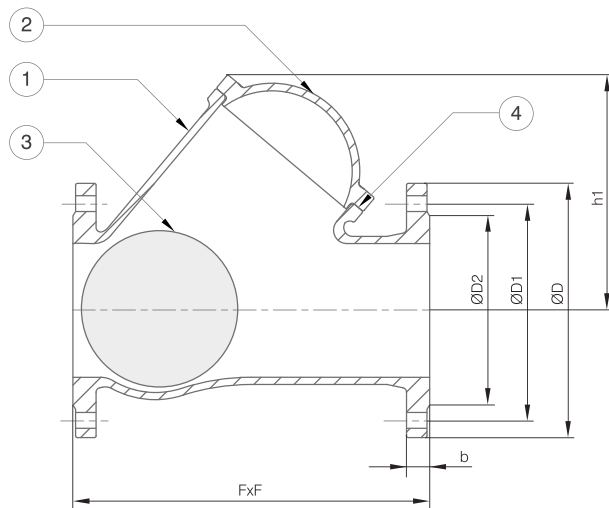

FIG. 2 Flanged connection

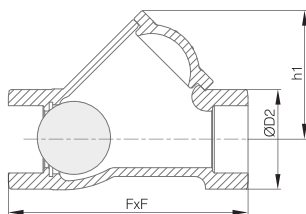
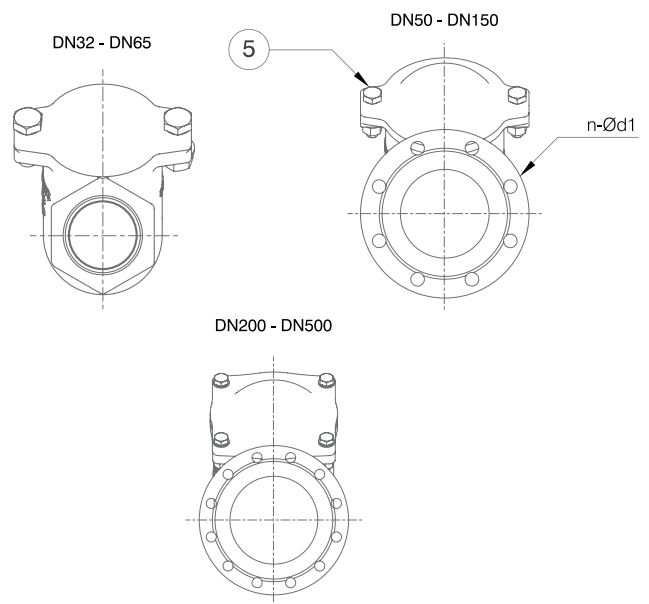

FIG. 3 Threaded connection

Factory accredited



ISO 90001:2008



CE879



ISO 90001:2000



ISO 90001:2008



CE0879

Pressure Drop Graph

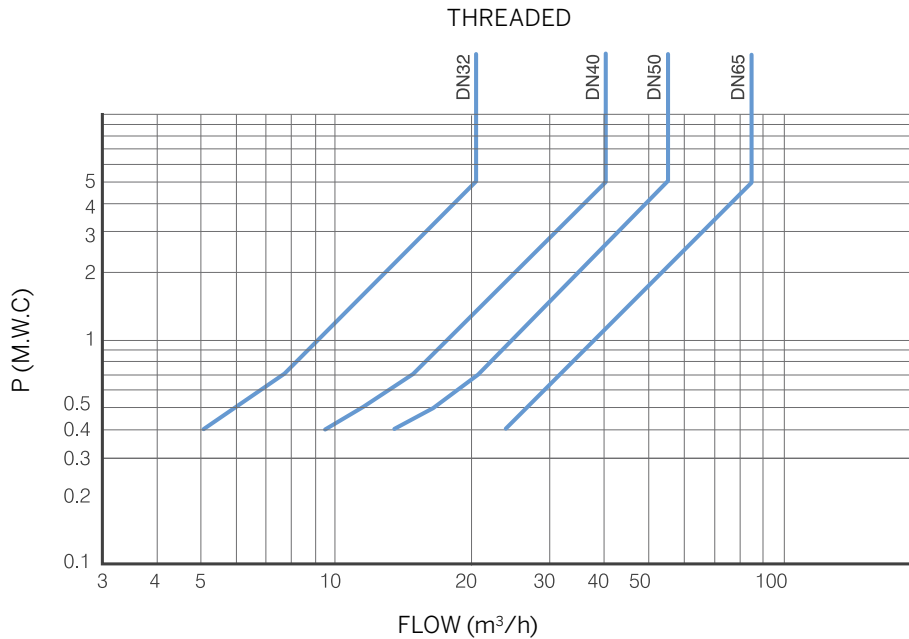
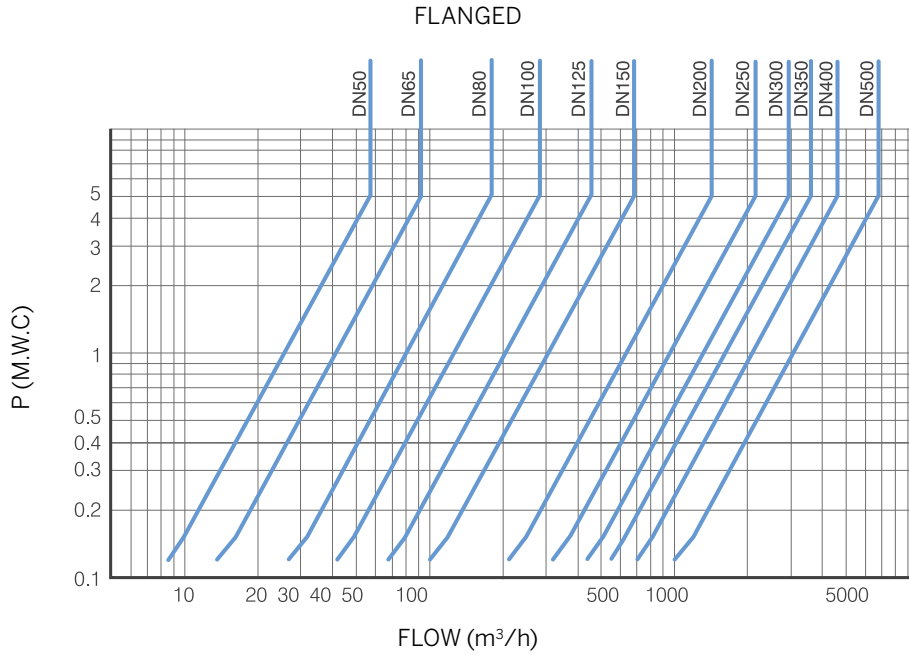

Scan for more information

Disclaimer: While every effort has been made to ensure that the information in this document is correct and accurate, users of Hygrade Water product or information within this document must make their own assessment of suitability for their particular application. Product dimensions are nominal only, and should be verified if critical to a particular installation. No warranty is either expressed, implied, or statutory made by Hygrade Water unless expressly stated in any sale and purchase agreement entered into between Hygrade Water and the user.

November 2022